

# SPECIFICATIONS

for your print and production data

## 1. File formats

Preferred file formats: .AI, .TIFF, .PDF, and .EPS



For the following formats, please include images and fonts or, alternatively, convert fonts to paths: .AI



Not accepted: .CDR, .INDD und .PSD



If you use Photoshop, InDesign, or CorelDraw, convert the file to a .PDF format before sending.

## 2. File transfer

Files < **8 MB** are welcome **via email** to [daten@kbz-werbetchnik.de](mailto:daten@kbz-werbetchnik.de).

For files **larger than 8 MB**, we recommend **transferring via a download link**, e.g., via [www.wetransfer.com](http://www.wetransfer.com) (free of charge and without registration).

### 3. Printing

3.1. Ideally, data should be delivered in the CMYK color space. File and image links should always be created in the same color space. There might be color deviations from the images on your monitor or the printout created with your printer.

3.2. We use the Coated FOGRA39 print profile. Please submit your data in the same format if possible.

3.3. Optimal resolution for images: 75 dpi -150 dpi (at 1:1 final format)

3.4. Scale



3.4. Please also add a bleed allowance of at least 3mm at a scale of 1:1.

3.5. Crop and registration marks are not required.

3.6. Please specify the final format in the file name.

**Example:** 250000\_KBZ\_Druck\_400x250mm.pdf

3.5. Print format: Please specify the desired division if the working width is exceeded.

Roll printer	Board printer
1520 mm wide max.	1600 x 3050 mm max.

## 4. Plot

4.1. For graphics with vectors, scale them 1:1 if possible or specify a scale/dimensions.

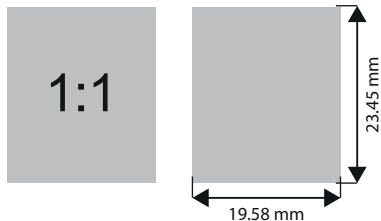

4.2. The outline of your graphic is the plot line. If lines intersect, they should be merged if possible. If the outline has a line thickness that should be visible in the slide cut, convert it to a fill.

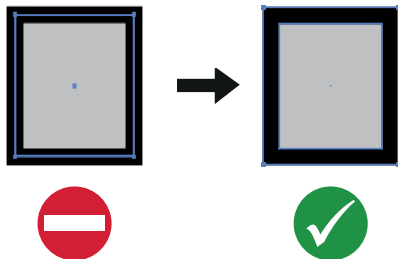

4.3. The quality of the plot depends on the graphics provided. Fonts should always be converted to outlines or included.

4.4. **Attention: Pixel graphics/images are not plottable!**

## 5. Colors

5.1. Unfortunately, **special colors cannot always be reproduced** exactly the same way, but we do our best to match the desired shade as accurately as possible.

5.2. Regarding **reprints**, minor deviations might occur from the printed product you received previously, due to material and technology variations. Unfortunately, this cannot always be avoided depending on the timing of the reprint.

## 6. Contour cut

6.1. If a graphic is to be contour-cut, the corresponding vector path should be embedded in the file and positioned on the desired cutting edge. Please also add a bleed of at least 3 mm.

6.2. Create the cut path in 100% magenta as a solid color with the name "CutContour" on the topmost layer and set the cut path to "Overprint Contour" in the "Attributes" window.

